



Perfection
Kitchens

Guide to Measuring Your Kitchen



PerfectionKitchens.Com
(732) 270-9300

MEASURING OVERVIEW

In the remodeling process, precise measurements are very important. Large delays and expensive over runs are caused by measurement errors.

It is strongly recommended that you have your room measured by your professional installer.

This guide will take you through three simple steps for creating sketches and providing input to your kitchen designer so they can begin the design process:

① Draw the Floor Plan

An ariel view of your kitchen

② Appliances

Which appliances you are planning for the new kitchen and what are their sizes

③ Photos

Snap pictures of each wall and an overall view

MEASUREMENT TIPS – Windows and Doors

Here are several pointers on how to take accurate measurements of your room and record accurate window, door, and utility details for your floor plan and wall elevation drawings. Double-check your dimensions at all times!

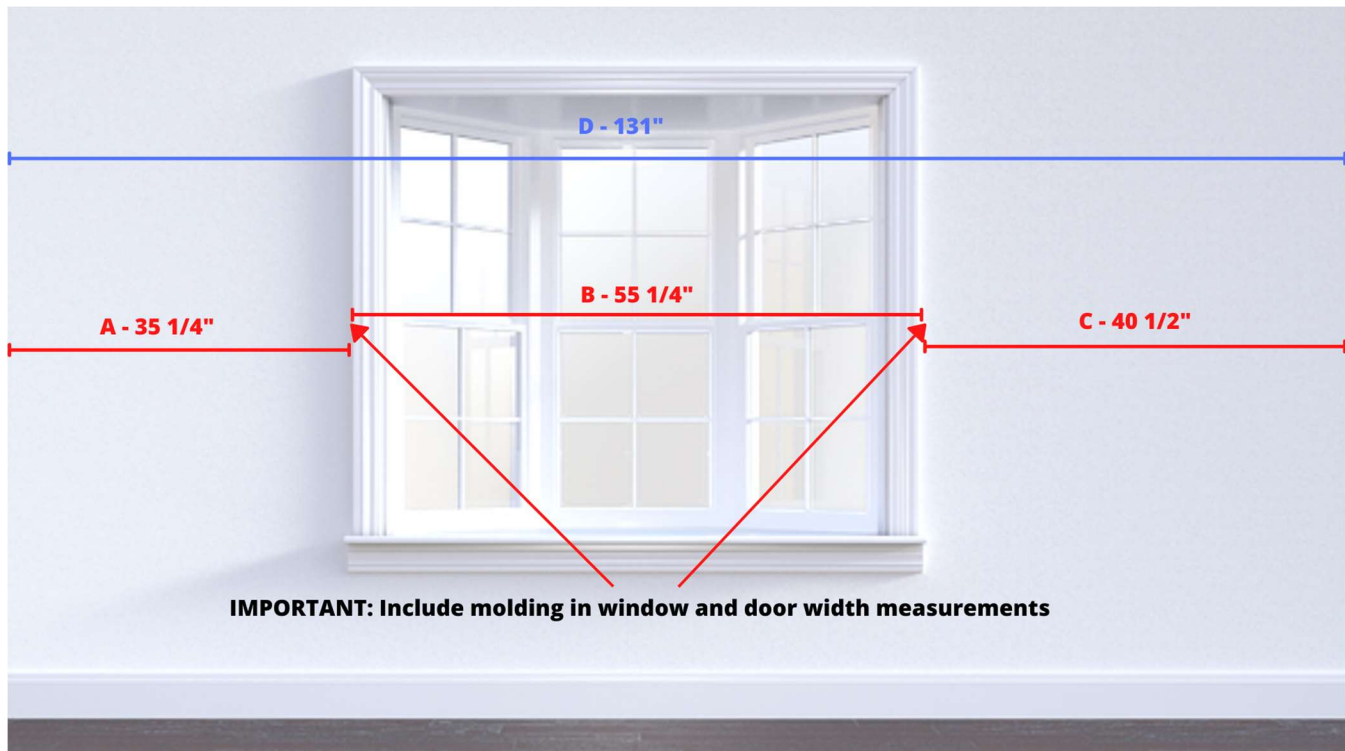

- 1) When you measure a window or door, always remember that we can't install cabinets on top of your molding. So please, include the molding in your window and door measurement.
- 2) Measure each wall segment separately (ie: A, B and C).
- 3) The measure the overall wall width (ie: D)
- 4) The segments (A,B and C) should equal the overall wall width (D).

MEASUREMENT TIPS – Sinks and Hoods

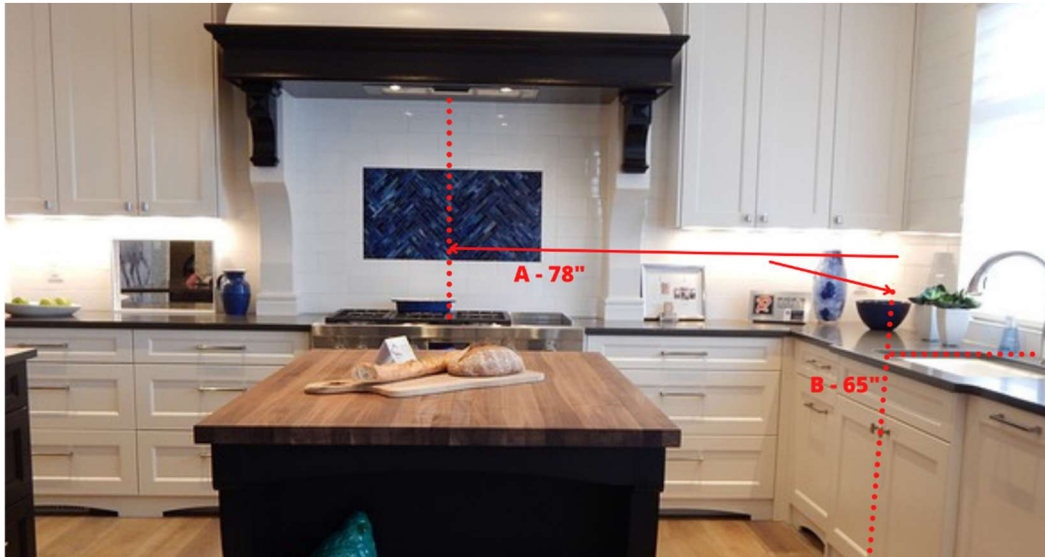

If you would like your hood and sink to stay in the same location, please measure from the corner (if possible) to the center line of each (ie: A and B).

MEASUREMENT TIPS – Ceilings and Other Obstacles

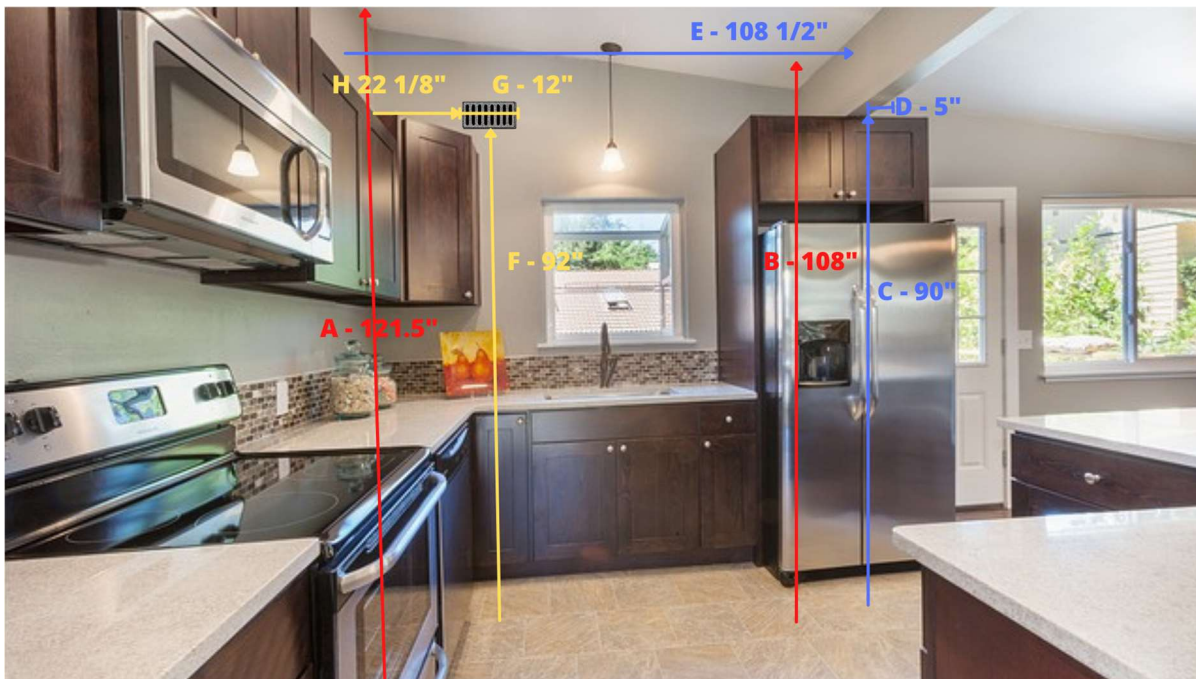

Ceiling Height – Measure the highest and lowest locations (ie A and B)

Beams – Measure the height to the bottom (C), the width (D) and the distance from the perpendicular wall to the beam (E).

Vents – Measure from the floor to the bottom of the vent (F), the width of the vent (G) and the distance from the wall to the edge of the vent (H).

1 CREATE A FLOOR PLAN DRAWING

A Floor Plan is an ariel view of your kitchen, showing all walls, windows, doors, and the location of appliances that need to stay in the same location

Start with your wall drawings

On a blank sheet of paper, start drawing your floor plan starting with the sink wall. Continue to draw each wall around the room, marking the locations of doors and windows as well. Please note: The drawing does not need to be to scale, so just a rough sketch of the wall lengths will suffice. The measurements, on the other hand will need to be as exact as possible.

Measure each segment, window and door

Next, go around the room and measure each segment as well as the overall wall length. Please be sure to include window in door molding into the window or door measurement.

Please double-check your measurements!

The total of your wall segments should equal your overall wall length.

In Example, the sink wall should match up as follows:

Segment 1 (105") + Window (54") + Segment 2 (108)

= Overall Wall Length of 267"

Locate the centerlines of appliances

If any appliances or sinks must stay in the exact same location, please measure from the side wall to the center line of that item and mark it.

Please note that it is most important to write down the exact measurements than to draw the layout to scale.

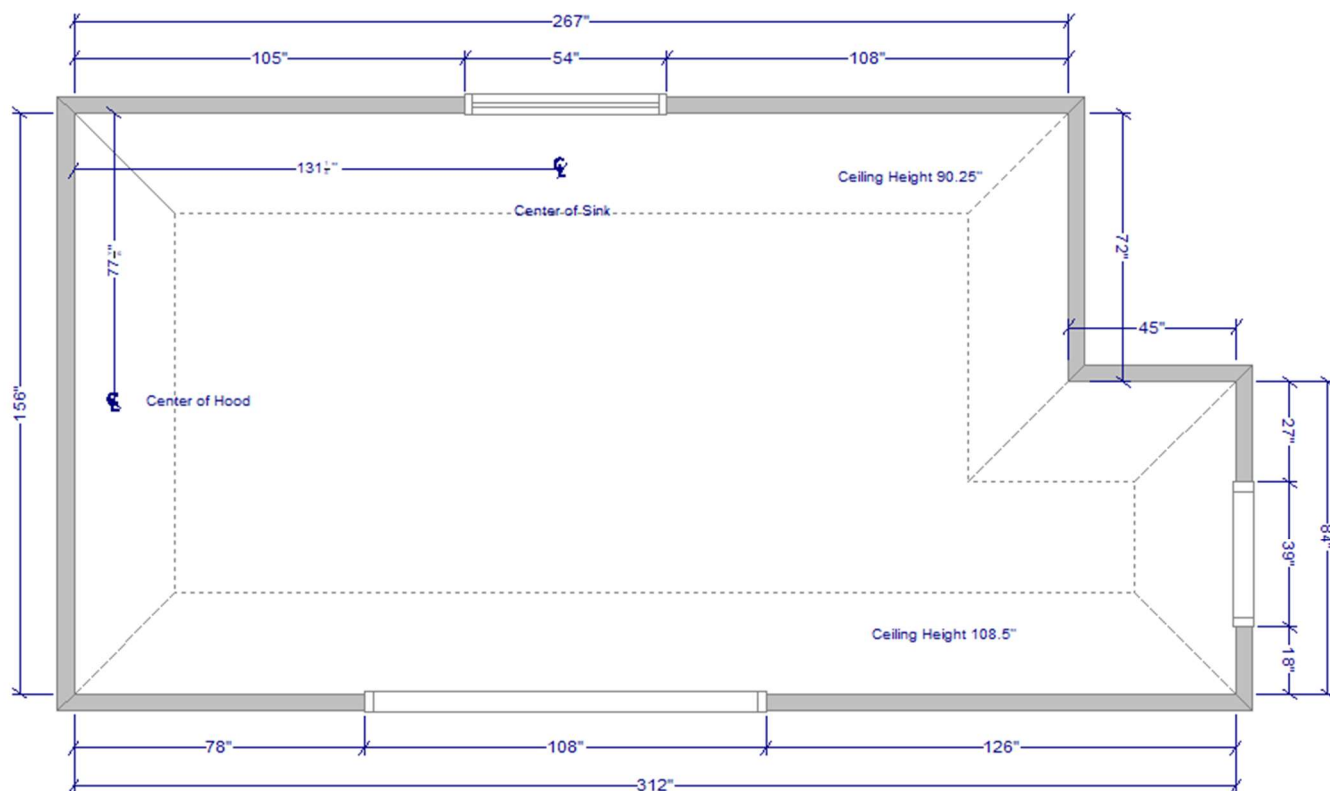

2 APPLIANCES and CABINETRY SELECTION

Appliances come in a wide variety of different sizes and sometimes need to be put in specific placements within the kitchen. Additionally, sometimes we need to create extra clearance space in order for appliances doors to open up all the way.

Please provide the brand name and model number for all appliances whenever possible. These typically are found on the appliance specification which is typically available on the product listing online or in the installation manual.

Appliance	Yes/No	Brand	Model	Width	Depth	Height
Refrigerator						
Range						
Range Hood						
Microwave						
Cook/Range Top						
Wall Oven						
Dishwasher						
Sink						
Other:						
Other:						

Cabinet Style(s) of Interest: _____

If you know other options you are looking for such as which countertop (ie granite Moon White) , backsplash or flooring tile, just let us know below. A great place to get started going through cabinetry and other options is at PerfectionKitchens.com

3 PHOTOS

- 1) Take a photo that shows a straight on view of each wall in the kitchen so we can see the wall from floor to ceiling.
- 2) Take a photo (or 2 if needed) of the overall room so we can see how each wall flows together.
- 3) Please take photos of any thing that is unique about your kitchen such as soffits, obstructions or vent covers

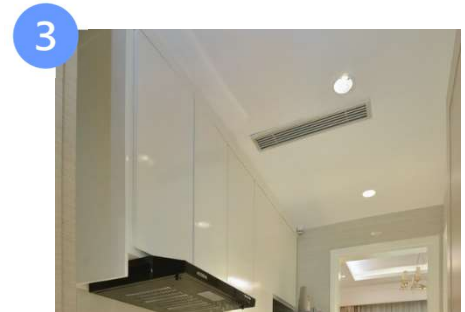

Please send this page, the photos and the measurement sheet to Quotes@PerfectionKitchens.com or take photos of each page and text everything to 732-313-3808

Customer Info:

 First Name Last Name Phone Number Email Address

 Street Address City State Zip Code

